

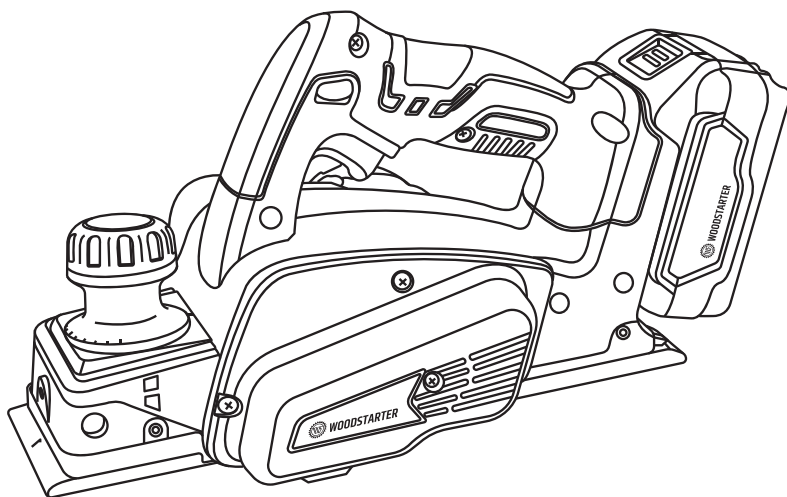

# WOODSTARTER



## Electric Cordless Hand Planer

CHP15K

### USER MANUAL V 1.0

\*Please read carefully before use. Please keep it for future reference.

# Content

<b>Safety Precautions .....</b>	<b>01</b>
<b>Specification .....</b>	<b>03</b>
<b>Part List .....</b>	<b>03</b>
<b>Assembly and Adjustments .....</b>	<b>04</b>
<b>Operation .....</b>	<b>07</b>
<b>Maintance .....</b>	<b>08</b>
<b>Warranty Information .....</b>	<b>10</b>

# Safety Precautions

## GENERAL SAFETY RULES

1. **Avoid Dangerous Conditions:** Do not operate power tools in wet or damp areas, and keep them away from rain. Ensure that your work area is well-lit, clean, and free of clutter. Avoid working on surfaces that are slippery due to sawdust or wax.
2. **Stay Away from Flammable Materials:** Refrain from using power tools in environments where flammable liquids or gases are present.
3. **Maintain Safe Distances:** Keep bystanders at a safe distance from the work area, especially while the tool is in use. Never allow children or pets to approach the tool.
4. **Use Tools Correctly:** Do not force the tool to perform tasks for which it was not designed.
5. **Dress for Safety:** When operating the tool, avoid wearing loose clothing, gloves, ties, or jewelry (such as rings and watches) that could get caught in moving parts. Always wear non-slip footwear and secure long hair.
6. **Wear Protective Gear:** Always use a face mask or dust mask to guard against sawdust produced during operations. Use safety goggles that meet ANSI Z87.1 standards, as standard safety glasses do not provide adequate protection. During extended use, wear hearing protection such as plugs or muffs.
7. **Disconnect Power:** Always unplug the power from the battery when making adjustments, changing parts, cleaning, or servicing the tool.
8. **Maintain Guards:** Ensure that all guards are properly installed and functioning.
9. **Prevent Accidental Start-Ups:** Before plugging in the power cord, confirm that the power switch is in the OFF position.
10. **Avoid Standing on Tools:** Never stand on the tool, as this can lead to serious injury if it tips over or is accidentally struck. Do not store items above or near the tool.
11. **Maintain Proper Balance:** Avoid overreaching; keep your footing and balance steady at all times. Wear oil-resistant rubber-soled footwear and keep the floor clear of oil, debris, and other hazards.

12. **Perform Regular Maintenance:** Keep tools clean and in good working order at all times. Follow the manufacturer's instructions for lubrication and changing accessories.
13. **Inspect for Damage:** Regularly check for proper alignment of moving parts, jamming, breakage, improper mounting, or any other conditions that may affect the tool's operation. Repair or replace any damaged parts before use.
14. **Operate Sober:** Do not use the tool if you are under the influence of drugs, alcohol, or medication that may impair your ability to operate it safely.

## **SPECIFIC RULES FOR THE PLANER**

1. Ensure the cutter has completely stopped before setting down the tool.  
A rotating cutter can engage surfaces, risking loss of control and serious injury.
2. Secure the workpiece using clamps or a stable support system. Hand-holding the workpiece can cause instability and potential loss of control.
3. Keep the work area clear of rags, cloth, cord, string, and similar items.
4. Do not cut materials with nails. Inspect and remove all nails from the workpiece before operation.
5. Use only sharp blades and handle them with extreme care.
6. Verify that blade installation bolts are securely tightened prior to operation.
7. Maintain a firm grip on the tool with both hands during use.
8. Keep hands clear of rotating parts to avoid injury.
9. Allow the tool to run briefly before engaging the workpiece to check for vibration or wobbling, which may indicate improper installation or blade imbalance.
10. Ensure the blade is not in contact with the workpiece before turning on the tool.
11. Wait for the blade to reach full speed before beginning the cut.
12. Always turn off the tool and wait for the blades to stop completely before making any adjustments.
13. Avoid inserting fingers into the chip chute. Use a stick to clear jammed chips, especially when cutting damp wood.
14. Do not operate the tool unattended. Use only when hand-held.

- 15. Replace both blades or covers on the drum simultaneously to prevent imbalance, which can cause vibration and reduce tool lifespan.
- 16. Always wear the appropriate dust mask or respirator for the material and application.

## Specification

Model	CHP15k
Rated Voltage	D.C. 20V
Non Load Speed	15,000 RPM
Cutting Width	3-1/4"
Cutting Depth	2/25"
Rabbeting Depth	2/5"

## Part List

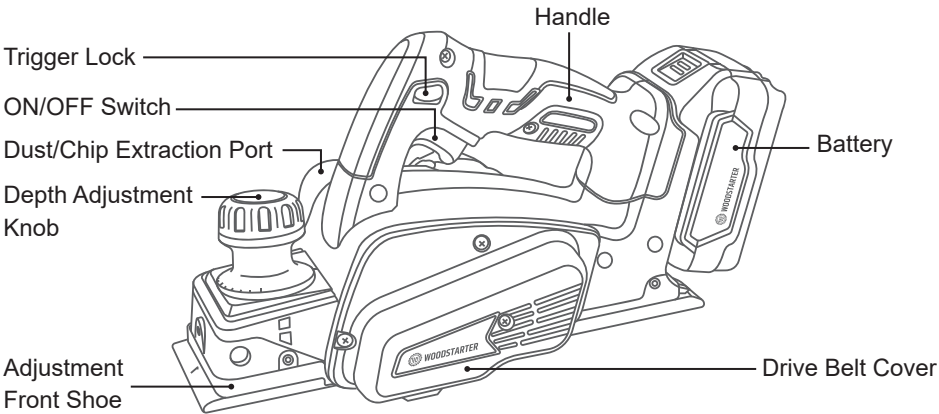

# Assembly and Adjustments

**CAUTION:** Always be sure that the tool is switched off and the battery cartridge is removed before carrying out any work on the tool.

## REMOVING OR INSTALLING PLANER BLADES

### CAUTION:

- **Secure Tightening:** Ensure blade installation bolts are firmly tightened. Loose bolts pose safety risks.
- **Handle with Care:** Use gloves or rags to protect hands during blade removal or installation.
- **Use Proper Tools:** Only use the provided wrench to avoid over-tightening or insufficient tightening, which may lead to injury.

1. Disconnect the planer from the power source.
2. Loosen all clamping screws using the supplied wrench.
3. Remove the blade.
4. Clear all chips and debris from the blade drum and blade.
5. Reverse the blade if one edge is dull; if both edges are dull, replace it with a new blade.
6. Insert the good blade face up into the drum's blade retainer, ensuring the ridge is opposite the clamping screws.
7. Tighten the clamping screws evenly.
8. Repeat for the second blade, ensuring both blades are at the same cutting level and centered in the drum to avoid a rough and uneven surface.

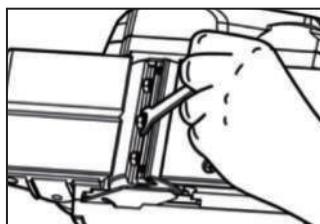

## BLADE ALIGNMENT

To ensure an even cut, align the blade with the outside edges of the front and rear shoes as follows:

1. Place a straight edge or a piece of wood along the outer surfaces of the front and rear shoes. Adjust the planer blade to just contact the straight edge or wood.
2. Verify that the blade is properly seated in the holder groove of the cutter drum.
3. Tighten the clamping screws to secure the blade, and then you can use your planer.

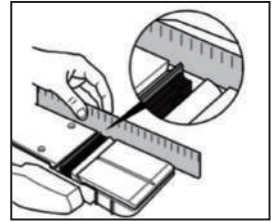

## FOR THE CORRECT BLADE SETTING

Your planing surface will end up rough and uneven, unless the blade is set properly and securely.

The blade must be mounted so that the cutting edge is absolutely level, that is, parallel to the surface of the rear base.

Refer to some examples below for proper and improper settings.

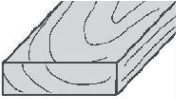
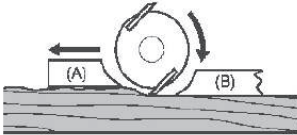
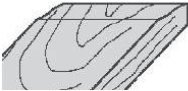
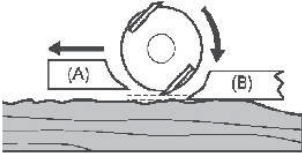
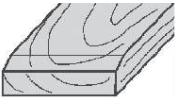
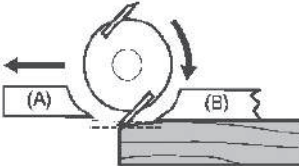
Planing Surface	Blade Setting	Cause
<p>Correct Setting</p> 		Although this side view cannot show it, the edge of the blades run perfectly parallel to rear base surface.
<p>Gouging at Start</p> 		Both blade edges fails to protrude enough in relation to rear base line.
<p>Gouging at End</p> 		One or both blade edges protrude too far in relation to rear base line.

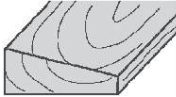
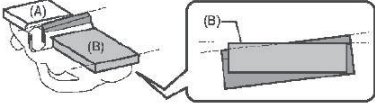
Planing Surface	Blade Setting	Cause
Aslope in Surface 		One or both blades fails to have edge parallel to rear base line.
<b>(A):</b> Front Base (Movable Shoe) <b>(B):</b> Rear Base (Stationary Shoe)		

## ADJUSTING THE DEPTH OF CUTTING

**CAUTION:** Always ensure that the tool is switched OFF and unplugged from the power supply before making adjustments or installing or removing blades. Wait until the blades come to a complete stop before adjusting the depth of the cut.

1. Disconnect the planer from the power source.
2. Rotate the depth adjustment knob clockwise for a deeper cut or counter-clockwise for a shallower cut.

The minimum cutting increment is  $\frac{1}{256}$ " (0.1 mm).

**NOTE:** If it is necessary to accurately determine the depth of cut, plane a scrap piece of wood, measure the difference in thickness and adjust the settings accordingly.

**CAUTION:** Always ensure that the number on the ring is at the "0" position when the tool is not in use. At this position, the blade cannot cut the workpiece.

## PARALLEL FENCE

**CAUTION:** Always verify that the tool is switched off and unplugged from the power supply. Wait for the blades to come to a complete stop before installing or adjusting the parallel fence.

1. Disconnect the planer from the power source.
2. Use the bracket fixing knob to secure the parallel fence bracket to the left side of the planer.
3. Slide the parallel fence onto the bracket and position it to the desired width.
4. Lock the parallel fence in place using the fence knob and coach bolt.



## SWITCHING ON AND OFF

**CAUTION:** Before plugging the machine into the power supply, always check that the trigger switch and trigger lock work properly.

The tool features a trigger lock to prevent unintentional start-ups. To turn on the planer, press and lift the trigger lock, then squeeze the trigger switch. To turn it off, simply release the trigger switch.

## Operation

### PLANING

1. Ensure the workpiece is securely held on your work surface. Grip the planer firmly with both hands, resting the front shoe flat on the workpiece without allowing the blades to contact it.
2. Turn on the tool and wait for the blades to reach full speed.
3. Gently move the tool forward, applying pressure at the front during the initial phase of planing and at the rear toward the end of the stroke.
4. Push the planer beyond the edge of the workpiece without tilting it downward.

**NOTICE:** For easier planing, incline the workpiece slightly away from you to plane “downhill.” The quality of the finish is influenced by the planing rate and cut depth. Increase the cut depth for rough cutting, but reduce it for a better finish while advancing the tool more slowly.

**NOTICE:** Moving the machine too quickly may result in poor cut quality and can damage the blades or motor. Conversely, moving too slowly can burn or mar the cut. The proper feed rate depends on the material type and cut depth. Practice on a scrap piece to determine the correct feed rate and cutting dimensions.

**CAUTION:** The motor may stall if improperly used or overloaded. Reduce the pressure (feed rate) or depth of cut to prevent possible damage to the tool if the motor labors.

## TOOL PARK REST

The park rest is designed to swing down, preventing the blade from contacting the work surface when the planer is not used. Additionally, the tool's park rest automatically swings up and out of the way when the back of the planer crosses the leading edge of the workpiece.

## CHAMFERING

1. Set the desired cut depth.
2. Position the “V” groove on the front adjustable shoe over the edge to be beveled, ensuring the blades do not contact the workpiece. Apply weight on the depth adjustment knob to keep the “V” groove flat against the edge.
3. Firmly grip the tool with both hands, turn it on, and push the planer forward, applying steady pressure on the front adjustable shoe.

## Maintenance

1. **CARBON BRUSHES:** The brushes in your tool are designed for extended and reliable service. We recommend checking the brushes every two to six months to ensure optimal motor performance.
  - 1). **Regular Inspection:** Periodically remove and check the carbon brushes. Replace them if worn to the limit mark.
  - 2). **Clean and Free Movement:** Ensure brushes are clean and move smoothly within their holders.
  - 3). **Synchronized Replacement:** Always replace both carbon brushes simultaneously using identical replacements.

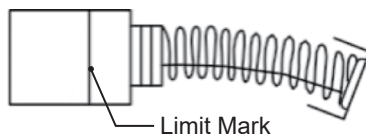

Use a screw driver to remove the chip cover.

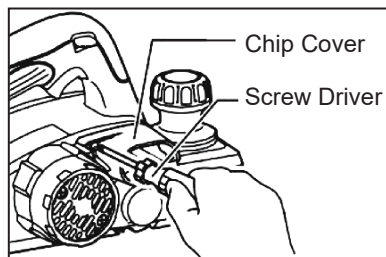

Use a screwdriver to remove the brush holder caps. Replace the worn carbon brushes with new ones and securely reattach the caps.

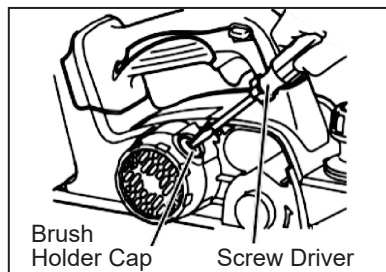

2. **TOOL LUBRICATION:** Your tool has been adequately lubricated and is ready for use. It is advisable to reapply a specialized gear lubricant to tools with gears during each brush change.
3. **CLEANING:** Keep ventilation openings and switch levers clean and free from debris. Avoid using pointed objects to clean these components by inserting them through openings.
4. **BEARINGS:** If bearings become noisy due to heavy loads or cutting through abrasive materials, they should be replaced promptly to prevent overheating or motor damage.

**WARNING:** Certain cleaning agents and solvents can harm plastic components. Examples include gasoline, carbon tetrachloride, chlorinated cleaning solvents, ammonia, and household detergents that contain ammonia.

**WARNING:** To prevent accidents, always unplug the tool from the power source prior to cleaning or conducting any maintenance. The most effective method for cleaning the tool is with compressed dry air. Always wear safety goggles when using compressed air for cleaning.

## Warranty Information

WOODSTARTER offers a one-year warranty along with lifetime technical support to ensure your satisfaction. For any inquiries or feedback, please contact our team at [\*\*support@woodstarter.com\*\*](mailto:support@woodstarter.com) or visit our support page at [\*\*www.woodstarter.com\*\*](http://www.woodstarter.com) for assistance.



**WOODSTARTER**

EMPOWERING  
YOUR WOODWORKING JOURNEY

If you need any assistance, please contact us via:

✉ Email: [support@woodstarter.com](mailto:support@woodstarter.com)



[www.woodstarter.com](http://www.woodstarter.com)

2330 Paseo Del Prado, C303,

Las Vegas, NV 89102

**MADE IN CHINA**

