

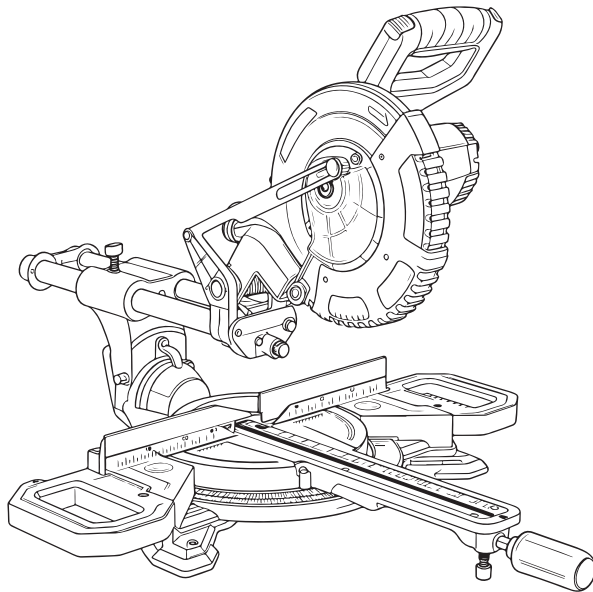

WOODSTARTER



Cordless Miter Saw

MS08C

USER MANUAL V 1.0

*Upon receipt of the product, read and follow all safety rules, operating instructions before first use it. And retain this manual for future reference.

Content

Instructions for Use	01
Technical Data	06
Attachment and Operation.....	09
Disposal and Recycling.....	13
Warranty Information	13

Instructions for Use



WARNING!

Read all safety warnings and instructions, illustrations and specifications provided with this power tool. Failure to follow all instructions listed below may result in electric shock, fire or serious injury.

Save all warnings and instructions for future reference.

The term "power tool" in the warnings refers to your battery-operated (cordless) power tool.

1) WORK AREA SAFETY

- a) Keep work area clean and well lit. Cluttered or dark areas invite accidents.
- b) Do not operate power tools in explosive atmospheres, such as in the presence of flammable liquids, gasses or dust. Power tools create sparks which may ignite the dust or fumes.
- c) Keep children and bystanders away while operating a power tool. Distractions can cause you to lose control.

2) ELECTRICAL SAFETY

- a) Power tool plugs must match the outlet. Never modify the plug in any way. Do not use any adapter plugs with earthed (grounded) power tools. Unmodified plugs and matching outlets will reduce risk of electric shock.
- b) Avoid body contact with earthed or grounded surfaces, such as pipes, radiators, ranges and refrigerators. There is an increased risk of electric shock if your body is earthed or grounded.
- c) Do not expose power tools to rain or wet conditions. Water entering a power tool will increase the risk of electric shock.
- d) Do not abuse the cord. Never use the cord for carrying, pulling or unplugging the power tool. Keep cord away from heat, oil, sharp edges or moving parts. Damaged or entangled cords increase the risk of electric shock.
- e) When operating a power tool outdoors, use an extension cord suitable for outdoor use. Use of a cord suitable for outdoor use reduces the risk of electric shock.

- f) If operating a power tool in a damp location is unavoidable, use a residual current device (RCD) protected supply. Use of an RCD reduces the risk of electric shock.

3) PERSONAL SAFETY

- a) Stay alert, watch what you are doing and use common sense when operating a power tool. Do not use a power tool while you are tired or under the influence of drugs, alcohol or medication. A moment of inattention while operating power tools may result in serious personal injury.
- b) Use personal protective equipment. Always wear eye protection. Protective equipment such as dust mask, non-skid safety shoes, hard hat, or hearing protection used for appropriate conditions will reduce personal injuries.
- c) Prevent unintentional starting. Ensure the switch is in the off-position before connecting to power source and/or battery pack, picking up or carrying the tool. Carrying power tools with your finger on the switch or energizing power tools that have the switch on invites accidents.
- d) Remove any adjusting key or wrench before turning the power tool on. A wrench or a key left attached to a rotating part of the power tool may result in personal injury.
- e) Do not overreach. Keep proper footing and balance at all times. This enables better control of the power tool in unexpected situations.
- f) Dress properly. Do not wear loose clothing or jewelry. Keep your hair and clothing away from moving parts. Loose clothes, jewelry or long hair can be caught in moving parts.
- g) If devices are provided for the connection of dust extraction and collection facilities, ensure these are connected and properly used. Use of dust collection can reduce dust-related hazards.
- h) Do not let familiarity gained from frequent use of tools allow you to become complacent and ignore tool safety principles. A careless action can cause severe injury within a fraction of a second.

4) POWER TOOL USE AND CARE

- a) Do not force the power tool. Use the correct power tool for your application. The correct power tool will do the job better and safer at the rate for which it was designed.

- b) Do not use the power tool if the switch does not turn it on and off. Any power tool that cannot be controlled with the switch is dangerous and must be repaired.
- c) Disconnect the plug from the power source and/or remove the battery pack, if detachable, from the power tool before making any adjustments, changing accessories, or storing power tools. Such preventive safety measures reduce the risk of starting the power tool accidentally.
- d) Store idle power tools out of the reach of children and do not allow persons unfamiliar with the power tool or these instructions to operate the power tool. Power tools are dangerous in the hands of untrained users.
- e) Maintain power tools and accessories. Check for misalignment or binding of moving parts, breakage of parts and any other condition that may affect the power tool's operation. If damaged, have the power tool repaired before use. Many accidents are caused by poorly maintained power tools.
- f) Keep cutting tools sharp and clean. Properly maintained cutting tools with sharp cutting edges are less likely to bind and are easier to control.
- g) Use the power tool, accessories and tool bits etc. in accordance with these instructions, taking into account the working conditions and the work to be performed. Use of the power tool for operations different from those intended could result in a hazardous situation.
- h) Keep handles and grasping surfaces dry, clean and free from oil and grease. Slippery handles and grasping surfaces do not allow for safe handling and control of the tool in unexpected situations.

5) SERVICE

Have your power tool serviced by a qualified repair person using only identical replacement parts. This will ensure that the safety of the power tool is maintained. **Safety instructions for miter saws**

- a) Miter saws are intended to cut wood or wood-like products, they cannot be used with abrasive cut-off wheels for cutting ferrous material such as bars, rods, studs, etc. Abrasive dust causes moving parts such as the lower guard to jam. Sparks from abrasive cutting will burn the lower guard, the kerf insert and other plastic parts.

- b) Use clamps to support the workpiece whenever possible. If supporting the workpiece by hand, you must always keep your hand at least 100 mm from either side of the saw Original manual blade. Do not use this saw to cut pieces that are too small to be securely clamped or held by hand. If your hand is placed too close to the saw blade, there is an increased risk of injury. from blade contact.
- c) The workpiece must be stationary and clamped or held against both the fence and the table. Do not feed the workpiece into the blade or cut "freehand" in any way. Unrestrained or moving workpieces could be thrown at high speeds, causing injury.
- d) Push the saw through the workpiece. Do not pull the saw through the workpiece. To make a cut, raise the saw head and pull it out over the workpiece without cutting, start the motor, press the saw head down and push the saw through the workpiece. Cutting on the pull stroke is likely to cause the saw blade to climb on top of the workpiece and violently throw the blade assembly towards the operator.
- e) Never cross your hand over the intended line of cutting either in front or behind the saw blade. Supporting the workpiece "cross handed" i.e. holding the workpiece to the right of the saw blade with your left hand or vice versa is very dangerous.
- f) Do not reach behind the fence with either hand closer than 100 mm from either side of the saw blade, to remove wood scraps, or for any other reason while the blade is spinning. The proximity of the spinning saw blade to your hand may not be obvious and you may be seriously injured.
- g) Inspect your workpiece before cutting. If the workpiece is bowed or warped, clamp it with the outside bowed face toward the fence. Always make certain that there is no gap between the workpiece, fence and table along the line of the cut. Bent or warped workpieces can twist or shift and may cause binding on the spinning saw blade while cutting. There should be no nails or foreign objects in the workpiece.
- h) Do not use the saw until the table is clear of all tools, wood scraps, etc., except for the workpiece. Small debris or loose pieces of wood or other objects that contact the revolving blade can be thrown with high speed.
- i) Cut only one workpiece at a time. Stacked multiple workpieces cannot be adequately clamped or braced and may bind on the blade or shift during cutting.

- j) Ensure the miter saw is mounted or placed on a level, firm work surface before use. A level and firm work surface reduces the risk of the miter saw becoming unstable.
- k) Plan your work. Every time you change the bevel or miter angle setting, make sure the adjustable fence is set correctly to support the workpiece and will not interfere with the blade or the guarding system. Without turning the tool "ON" and with no workpiece on the table, move the saw blade through a complete simulated cut to assure there will be no interference or danger of cutting the fence.
- l) Provide adequate support such as table extensions, saw horses, etc. for a workpiece that is wider or longer than the table top. Workpieces longer or wider than the miter saw table can tip if not securely supported. If the cut-off piece or workpiece tips, it can lift the lower guard or be thrown by the spinning blade.
- m) Do not use another person as a substitute for a table extension or as additional support. Unstable support for the workpiece can cause the blade to bind or the workpiece to shift during the cutting operation, pulling you and the helper into the spinning blade.
- n) The cut-off piece must not be jammed or pressed by any means against the spinning saw blade. If confined, i.e. using length stops, the cut-off piece could get wedged against the blade and thrown violently. Original manual
- o) Always use a clamp or a fixture designed to properly support round material such as rods or tubing. Rods have a tendency to roll while being cut, causing the blade to "bite" and pull The work with your hand into the blade.
- p) Let the blade reach full speed before contacting the workpiece. This will reduce the risk of the workpiece being thrown.
- q) If the workpiece or blade becomes jammed, turn the miter saw off. Wait for all moving parts to stop and disconnect the plug from the power source and/or remove the battery pack. Then work to free the jammed material. Continued sawing with a jammed workpiece could cause loss of control or damage to the miter saw.
- r) After finishing the cut, release the switch, hold the saw head down and wait for the blade to stop before removing the cut-off piece. Reaching with your hand near the coasting The blade is dangerous.

- s) Hold the handle firmly when making an incomplete cut or when releasing the switch before the saw head is completely in the down position. The braking action of the saw may cause the saw head to be suddenly pulled downward, causing a risk of injury.
- T) Protect yourself and your environment from accidents using suitable precautionary measures! Do not look directly into the laser beam with unprotected eyes.

Never look into the path of the beam; Never point the laser beam toward reflecting surfaces and people or animals. Even a laser beam with a low output can cause damage to the eyes.

Caution - methods other than those specified here can result in dangerous radiation exposure.

Never open the laser module. Unexpected exposure to the beam can occur. If you do not use the device for a long time, the batteries should be removed. The laser may not be replaced with a different type of laser.

Repairs of the laser may only be carried out by the laser manufacturer or an authorized representative.

Technical Data

Li-ion Battery	DC 18V / 4.0Ah
Model	MS08C
No-load speed	4200RPM MAX
Disc Diameter	Φ210mm

A weighted sound pressure $L_{pA} = \text{dB(A)}$, $K_{pA} = 3 \text{ dB(A)}$

A weighted sound power $L_{wA} = \text{dB(A)}$, $K_{wA} = 3 \text{ dB(A)}$

Wear ear protection.

The effects of noise can cause a loss of hearing.

The above-mentioned noise emission values were measured in accordance with a standardized test procedure and can be used to compare one power tool with another.

The above-mentioned noise emission values can also be used for the preliminary assessment of exposure.



WARNING!

- The noise emissions during the actual use of the power tool may differ from the above-mentioned values depending on the power tool being used, in particular on the type of workpiece being processed.
- Try to keep emissions as low as possible, for example by limiting your working time. In this regard, all the operational cycle phases must be taken into consideration (such as the times when the tool is switched off or running idle).
- Open the packaging and remove the device carefully.
- Remove the packaging material as well as the packaging and transport bracing (if available).
- Check that the delivery is complete.
- Check the device and accessory parts for transport damage.
- If possible, store the packaging until the warranty period has expired.

ATTENTION:

The device and packaging materials are not toys! Children must not be allowed to play with plastic bags, film and small parts! There is a risk of swallowing and suffocation!

- The equipment must be set up where it can stand securely. Secure the machine on a workbench or a base frame with 4 screws (not included in delivery) using the holes on the fixed saw table (15). Pull out the pre-installed tilt protection (36) completely and secure it with an Allen key (D).
- All covers and safety devices have to be properly fitted before the equipment is switched on.
- It must be possible for the blade to run freely.
- When working with wood that has been processed before, watch out for foreign bodies such as nails or screws, etc.
- Before you press the ON/OFF switch, check that the saw blade is fitted correctly. Moving parts must run smoothly.

HOW TO INSTALL BATTERY PACK



- (1) installation, when you need to use the miter saw, take out the battery pack, align the handle battery pin and close.
- (2) When you need to remove the battery pack after completing the work, you can hold down the battery pack unlock button and pull it out by force.

MACHINE HEAD UNLOCKING

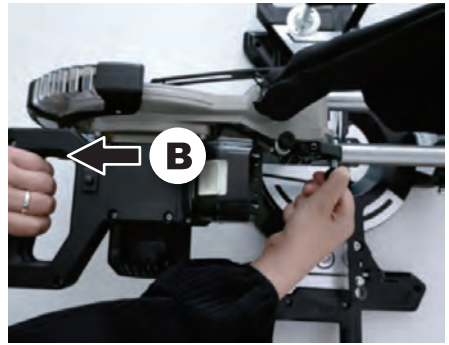
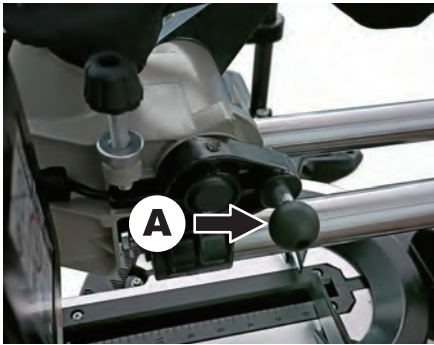

When the machine is taken out of the packing box, it is in the handling state. When we need to use the machine, we need to pull out the ball nut (A) to make the machine in the cutting state. If the ball nut (A) is too tight, the handle (B) should be pushed down a little, so that the ball nut (A) can be pulled out more easily.

Attachment and Operation



In order to adjust the rotary table, loosen the handle approximately 2 turns.

Turn the rotary table and pointer to the desired angle measurement on the scale and use the handle to secure it.

Pressing the machine head lightly downwards and removing the locking bolt from the motor bracket at the same time disengages the saw from the lowest position. Swing the machine head up.

It is possible to secure the clamping devices to the left or right on the fixed saw table. Insert the clamping devices in the holes on the rear side of the stop rail and secure it with the star grip screws.

For 0°- 45° miter cuts, the clamping device must only be mounted on the right side. It is possible to tilt the machine head a max. 45 to the left by loosening the set screw.

Workpiece supports must always be secured and used during work. Set the desired table size by loosening the set screw. Then tighten the set screw again.

CROSSCUT 90° AND TURNTABLE 0°



In the case of cutting widths up to approx. 100 mm, it is possible to fix the traction function of the saw with the set screw (A) in the rear position. In this position the machine can be operated in cross cutting mode. If the cutting width is over 100mm then it is necessary to ensure that the set screw (A) is loose and the machine head (D) can move.

Attention! For 90° crosscuts, the moveable stop rail (B) must be fixed in the inner position.

Open the set screw (B) for the moveable stop rail (B) and push the moveable stop rail (B) inwards.

The moveable stop rail (B) must be locked in a position far enough from the inner position that the distance between the stop rail (B) and the saw blade is no more than 8 mm.

Before making the cut, check that the stop rail (B) and the saw blade cannot collide. Re-tighten the set screw (B).

Move the machine head (D) to its upper position.

Use the handle (A) to push back the machine head (D) and fix it in this position if required (dependent on the cutting width).

Place the piece of wood to be cut at the stop rail (B) and on the turntable.

Lock the material with the clamping devices on the fixed saw table to prevent the material from moving during the cutting operation.

Release the lock switch and press the ON/OFF switch to start the motor.

START THE MACHINE



When the machine starts up, first use the thumb to open the tightening button (A), and then press the machine switch (B), then the power indicator light (C) will be opened at the same time. When the indicator light (C) flashes, it is to remind you that the battery pack will be out of power, please charge in time.

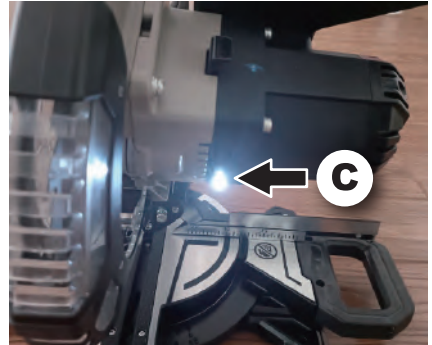

USING THE LASER SWITCH ON

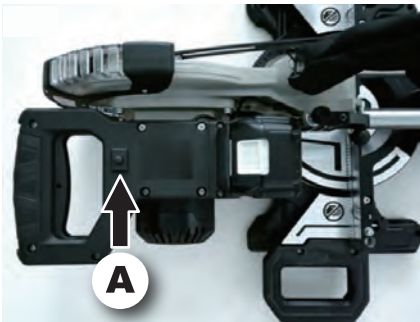

Press the ON/OFF switch laser (A) 1x. A laser line is projected onto the material you wish to process, providing an exact guide for the Switch of: Press the ON/OFF switch laser (A) 1x.

CHANGING THE SAW BLADE REMOVE THE POWER BATTERY

Important!

Wear safety gloves when changing the saw blade. Risk of injury!

1



2



3



4



Swing the machine head upwards and lock with the locking bolt. Loosen the retaining screw of the cover using a Philips screwdriver.

WARNING! Do not fully remove this screw. Fold the saw blade guard upwards until the saw blade guard is above the flange screw. With one hand, insert the Allen key into the flange screw. Hold the Allen key and slowly close the saw blade guard until it touches the Allen key. Firmly press the saw shaft lock and slowly rotate the flange screw in a clockwise direction. The saw shaft lock engages after no more than one rotation.

Now, using a little more force, slacken the flange screw in the clockwise direction. Turn the flange screw right out and remove the outer flange. Take the blade of the inner flange and pull it out downwards. Carefully clean the flange screw, outer flange and inner flange. Fit and fasten the new saw blade in reverse order.

Important! The cutting angle of the teeth, in other words the direction of rotation of the saw blade must coincide with the direction of the arrow on the housing.

Disposal and Recycling



The equipment is supplied in packaging to prevent it from being damaged in transit. The raw materials in this packaging can be reused or recycled.



The equipment and its accessories are made of various types of material, such as metal and plastic. Defective components must be disposed of as special waste. Ask your dealer or your local council.



Old devices must not be disposed of with household waste!

This symbol indicates that this product must not be disposed of together with domestic

Warranty Information

WOODSTARTER offers a one-year warranty along with lifetime technical support to ensure your satisfaction. For any inquiries or feedback, please contact our team at support@woodstarter.com or visit our support page at www.woodstarter.com for assistance.



WOODSTARTER
EMPOWERING

YOUR WOODWORKING JOURNEY

If you need any assistance, please contact us via:

✉ Email: support@woodstarter.com



www.woodstarter.com

2330 Paseo Del Prado, C303,
Las Vegas, NV 89102

MADE IN CHINA

